

Key

- Existing 'No waiting at any time' (double yellow lines)
- Proposed 'No waiting at any time' (double yellow lines)

Double yellow lines extended to prevent obstructive parking and ease bus movements

Double yellow lines to constrain parking to the east side of the road, to prevent obstructive parking on the bus route

Double yellow lines to prevent parking around junction

Revision	Date



Technical Services
 Gibson Building
 Gibson Drive
 Kings Hill
 West Malling
 Kent ME19 4LZ
 Tel: 01732 844522 Fax: 01732 876317

Project Title
 Local Parking Plan - Phase 9
 Formal consultation

Drawing Title
 Wouldham
 Hall Road



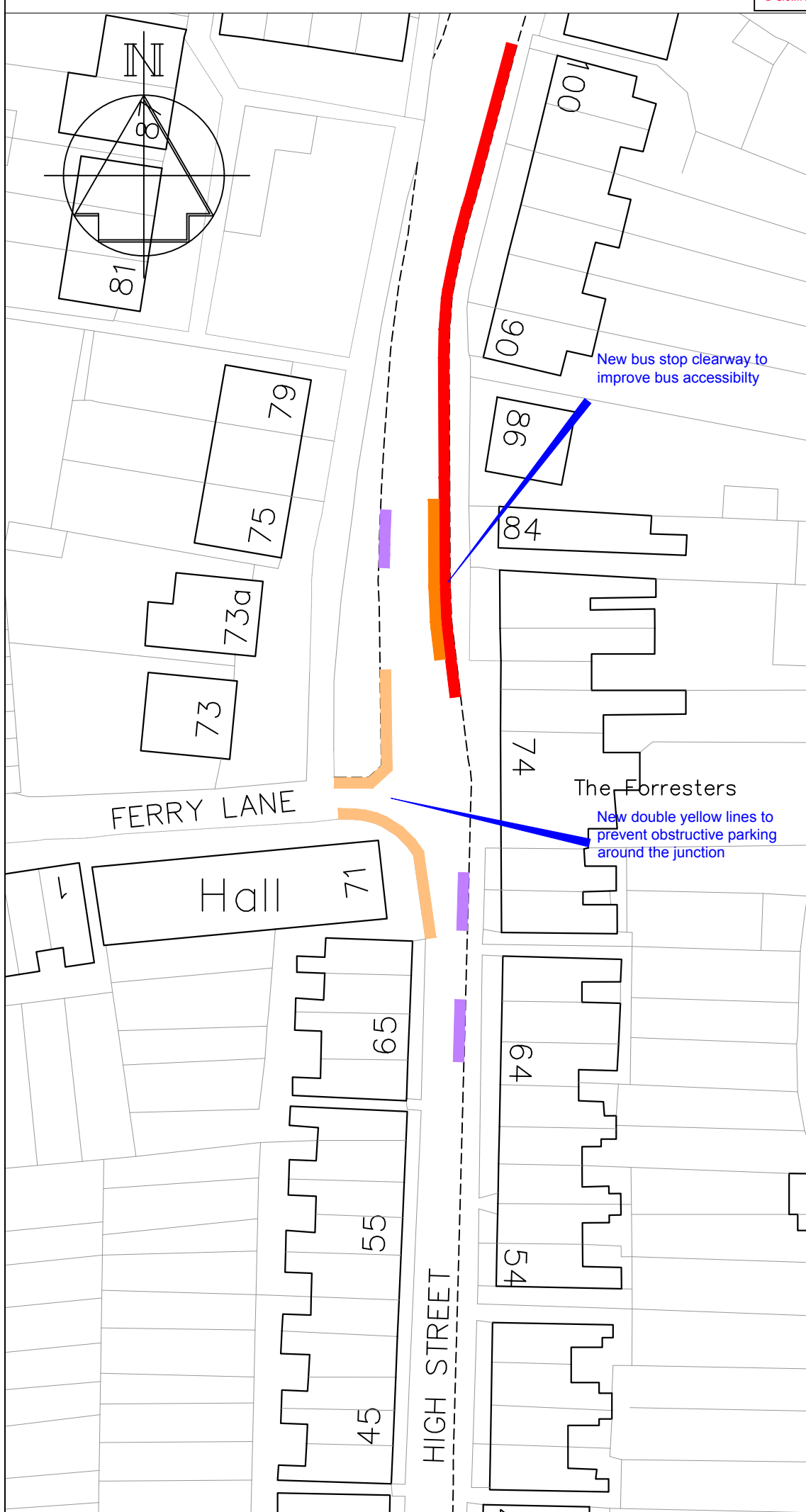

Drawn ACB	Checked ACB	Date	11/2016
-----------	-------------	------	---------

Scale 1:500 @ A4

Drawing No. DD/580/1	Rev -
--------------------------------	-----------------



Key

-  Existing 'No waiting at any time' (double yellow lines)
-  Proposed 'No waiting at any time' (double yellow lines)
-  Disabled parking bay
-  Proposed new bus stop clearway

New bus stop clearway to improve bus accessibility

New double yellow lines to prevent obstructive parking around the junction

The Forresters

Revision		Date	
			
Technical Services Gibson Building Gibson Drive Kings Hill West Malling Kent ME19 4LZ Tel: 01732 844522 Fax: 01732 876317			
Project Title Local Parking Plan - Phase 9 Formal consultation			
Drawing Title Wouldham Ferry Lane and High Street			
Drawn ACB	Checked ACB	Date	11/2016
Scale 1:500 @ A4			
Drawing No.			Rev
DD/580/2			-

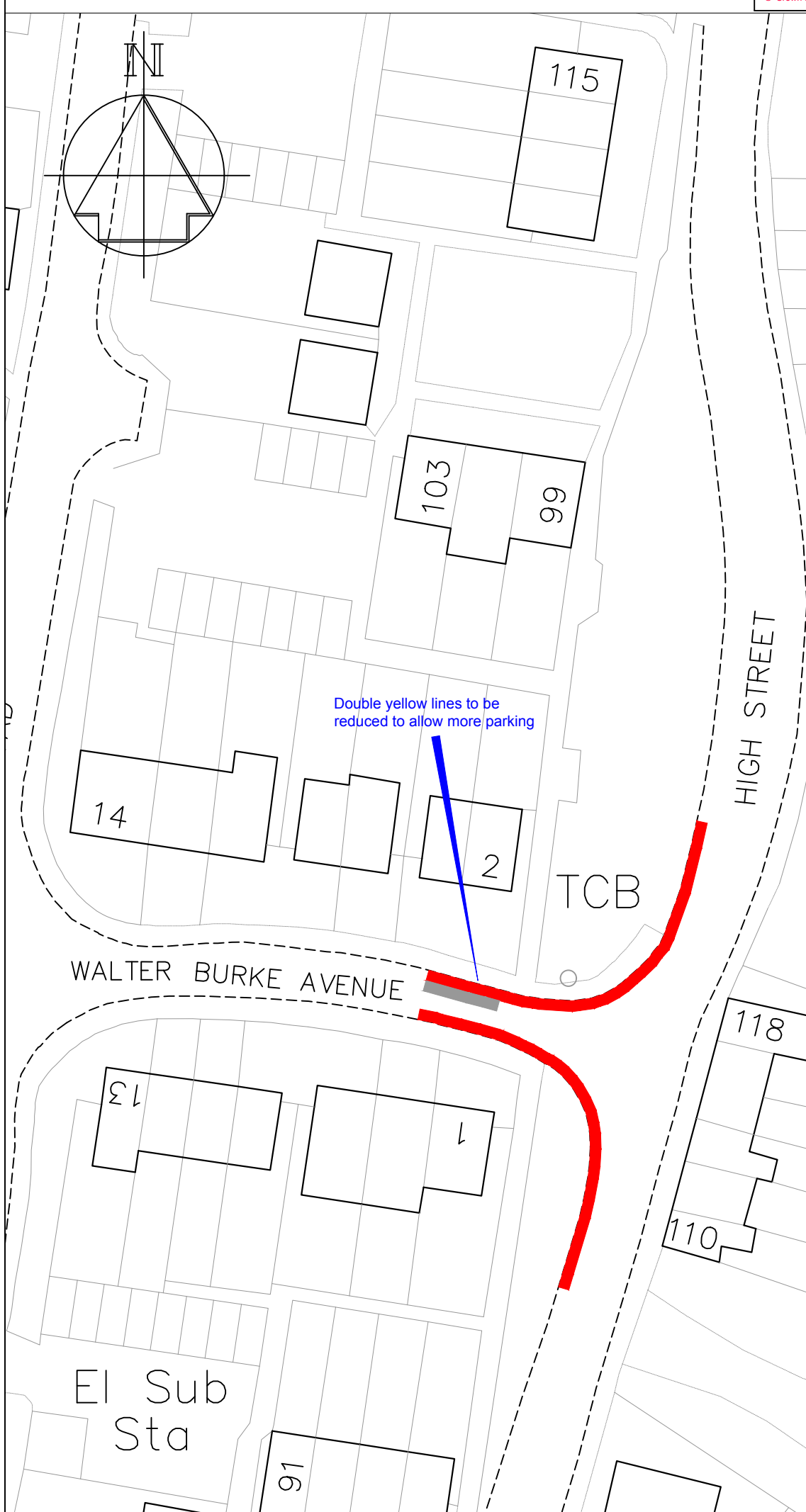

Key

- Existing 'No waiting at any time' (double yellow lines)
- Restrictions to be removed

A	DYLs altered	11/17
	Revision	Date



Technical Services
 Gibson Building
 Gibson Drive
 Kings Hill
 West Malling
 Kent ME19 4LZ
 Tel: 01732 844522 Fax: 01732 876317

Project Title
Local Parking Plan - Phase 9
 Formal consultation

Drawing Title
Wouldham
Walter Burke Avenue

Drawn ACB	Checked ACB	Date	11/2016
-----------	-------------	------	---------

Scale **1:500 @ A4**

Drawing No.	Rev
DD/580/3	A

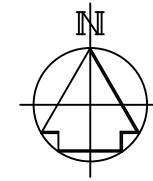

Key

- Existing 'No waiting at any time' (double yellow lines)
- Proposed 'No waiting at any time' (double yellow lines)
- Proposed 'bus stop clearway' (yellow bus stop marking)

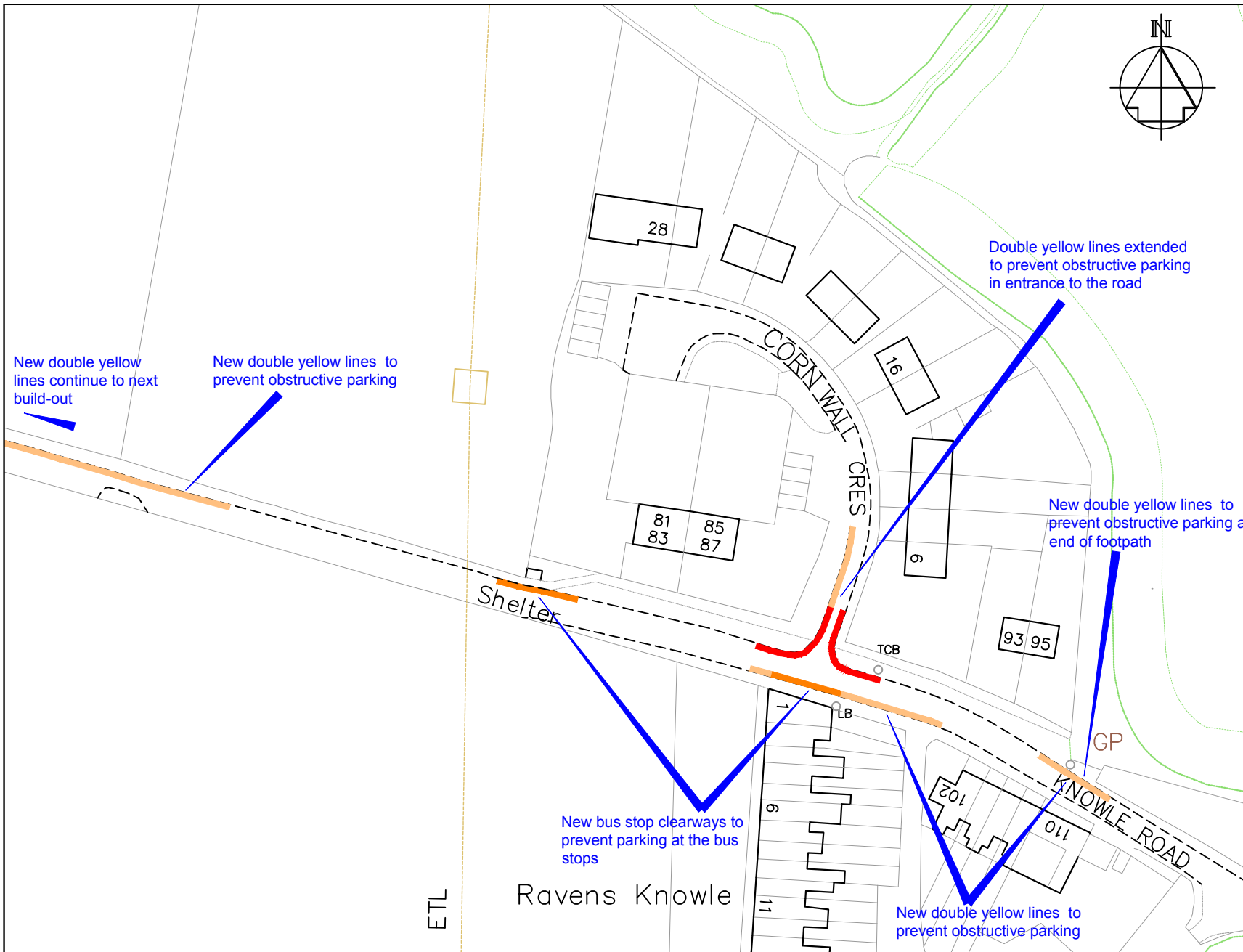

A	DYs extended	11/17
	Revision	Date
Drawn	Checked	Date
ACB	ACB	11/2016
Scale 1:1000 @ A4		
Drawing No. DD/580/5		Rev A



Technical Services
 Gibson Building
 Gibson Drive
 Kings Hill
 West Malling
 Kent ME19 4LZ
 Tel: 01732 844522 Fax: 01732 876317

Project Title
Local Parking Plan - Phase 9
 Formal consultation

Drawing Title
Wouldham
Knowle Road and Cornwall
Crescent

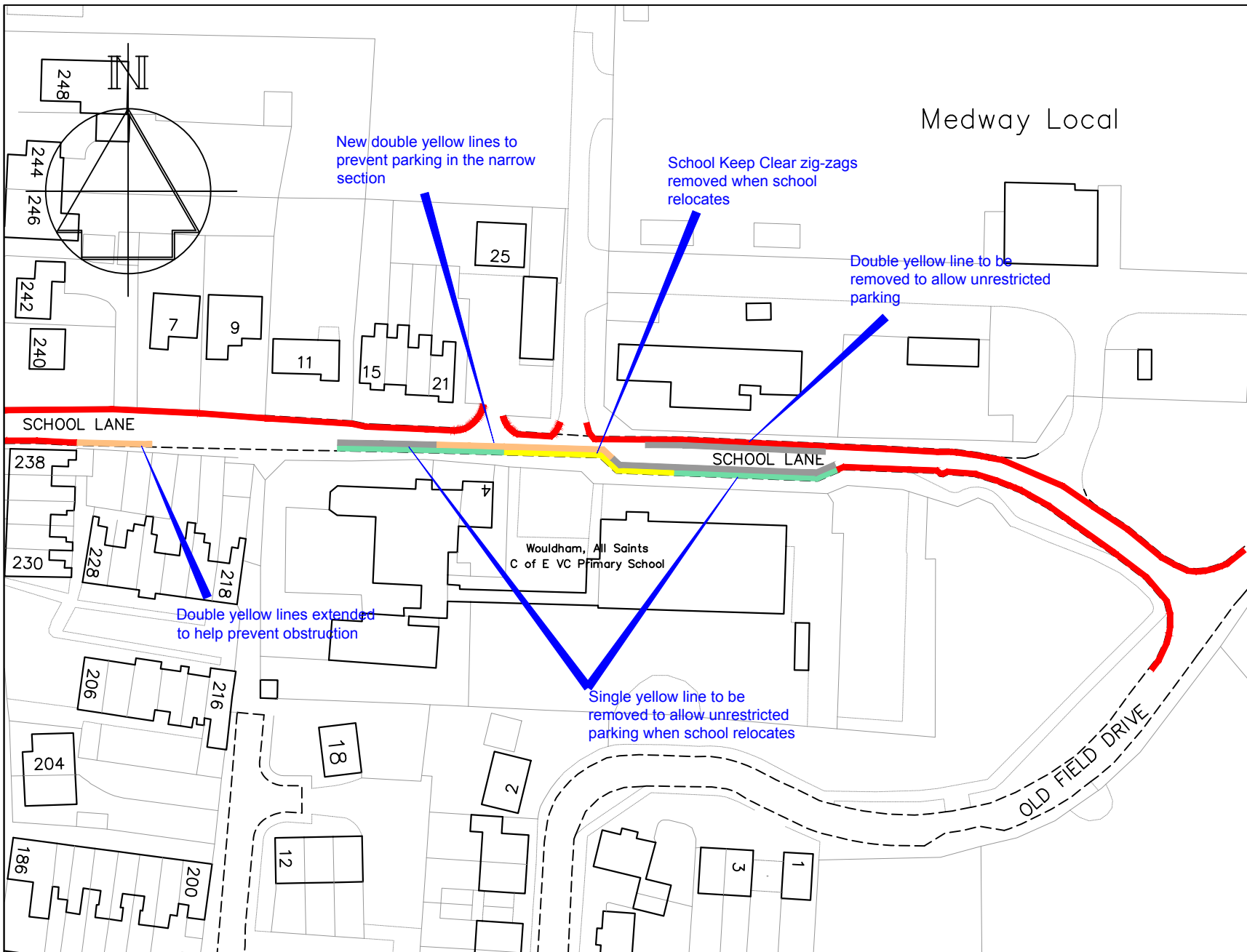

Key

- Existing 'No waiting at any time' (double yellow lines)
- Existing School Keep Clear (yellow zig-zags) - Monday to Friday 8:30am-3:30pm
- Existing no waiting, Monday to Friday 8am-4pm (single yellow line)
- Proposed 'No waiting at any time' (double yellow lines)
- Restrictions to be revoked to allow uncontrolled parking

B	DYLs changed	11/17
	Revision	Date
Drawn ACB	Checked ACB	Date 11/2016
Scale 1:1000 @ A4		
Drawing No. DD/580/6		Rev B



Technical Services
 Gibson Building
 Gibson Drive
 Kings Hill
 West Malling
 Kent ME19 4LZ
 Tel: 01732 844522 Fax: 01732 876317

Project Title
Local Parking Plan - Phase 9
 Formal consultation

Drawing Title
Wouldham School Lane

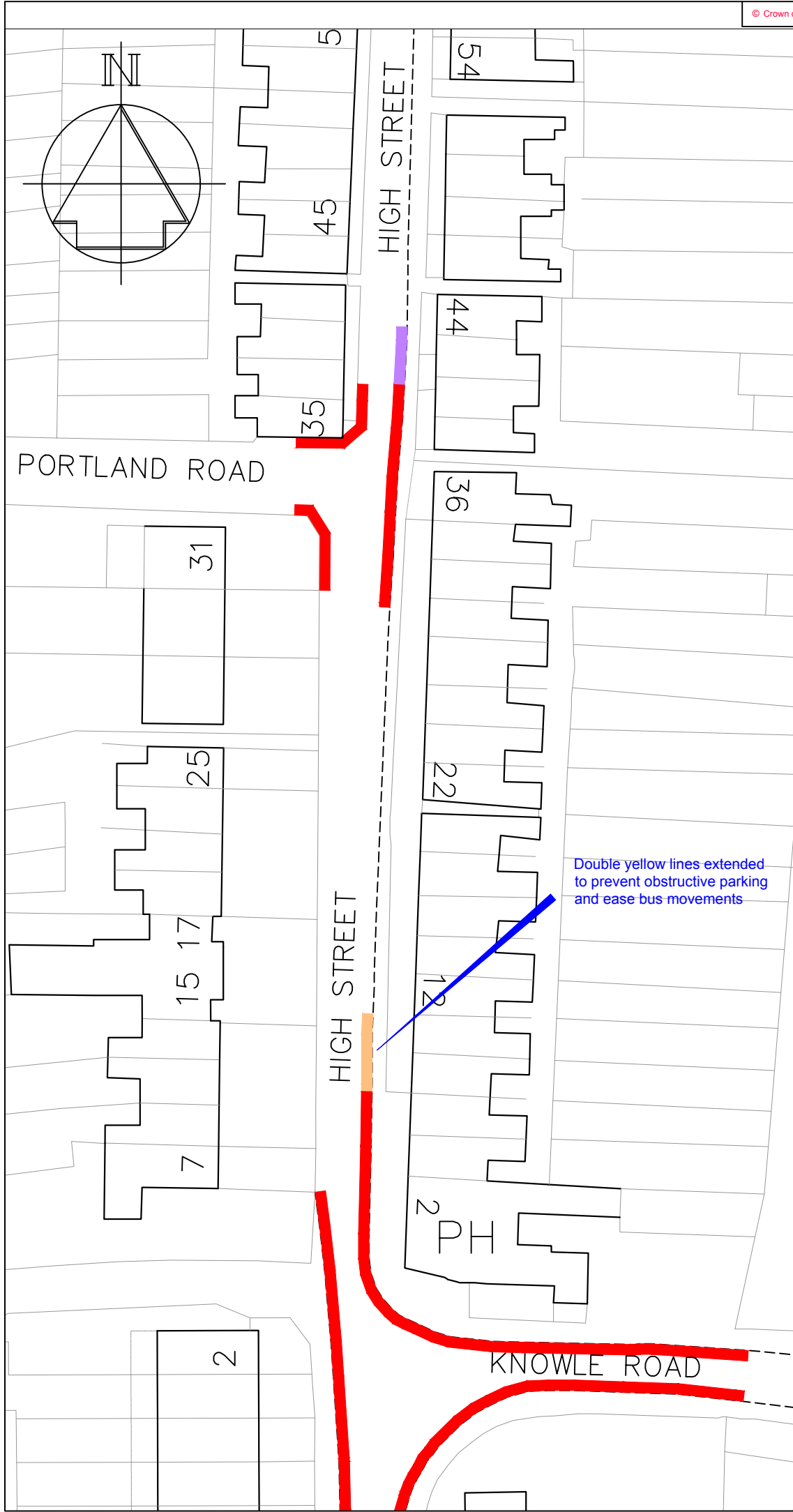

Key

- Existing 'No waiting at any time' (double yellow lines)
- Proposed 'No waiting at any time' (double yellow lines)
- Existing 'Disabled' bay

Revision	Date



Technical Services
 Gibson Building
 Gibson Drive
 Kings Hill
 West Malling
 Kent ME19 4LZ
 Tel: 01732 844522 Fax: 01732 876317

Project Title
 Local Parking Plan - Phase 9
 Informal consultation

Drawing Title
 Wouldham
 High Street (Knole Road to
 Portland Road)

Drawn ACB | Checked ACB | Date 11/2016
Scale 1:500 @ A4

Drawing No. DD/580/7	Rev -
--------------------------------	-----------------

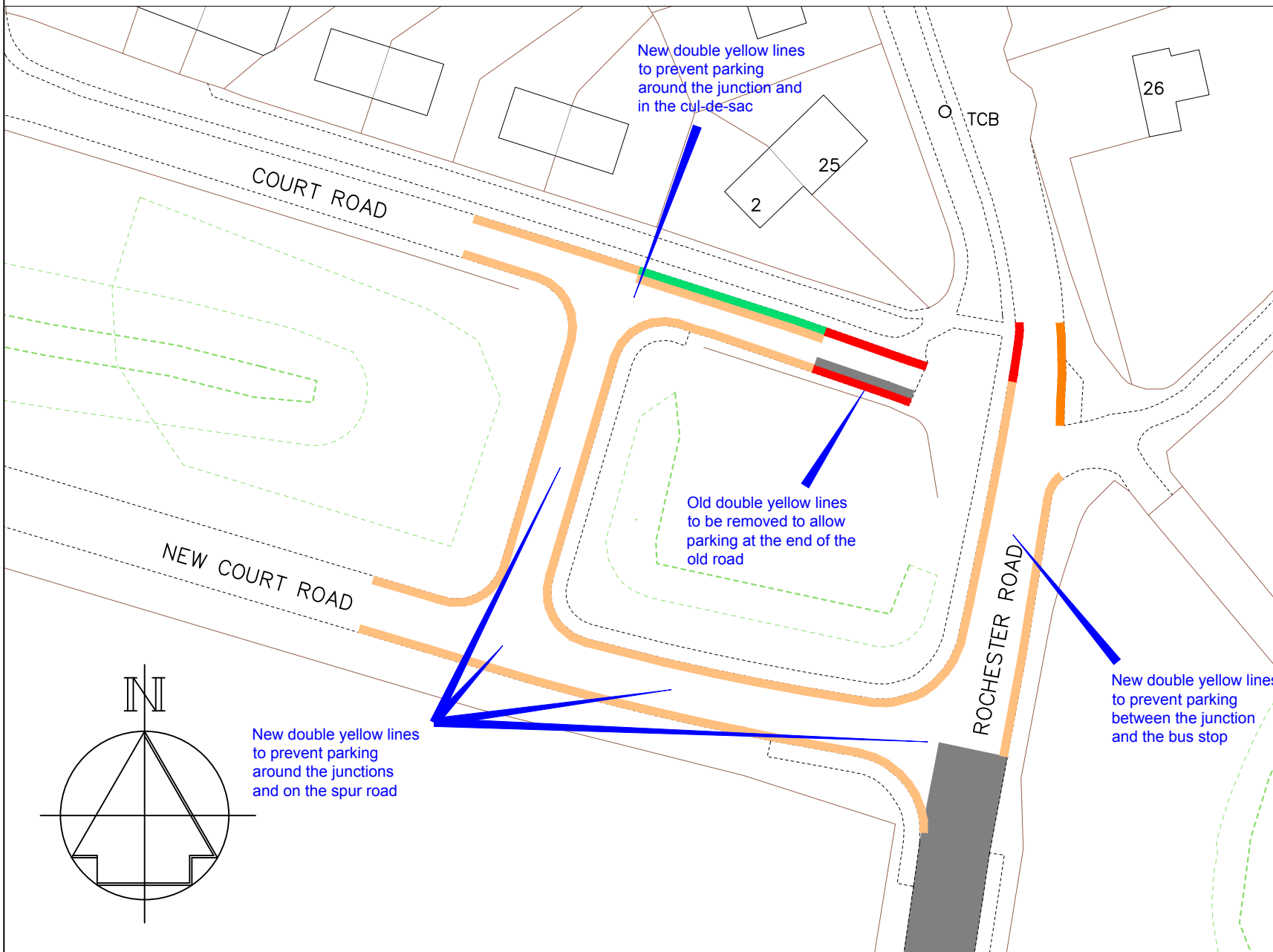

Key

- Existing 'No waiting at any time' (double yellow lines)
- Existing bus stop clearway
- Existing no waiting, Monday to Friday 9am-5pm (single yellow line)
- Proposed 'No waiting at any time' (double yellow lines)
- Proposed restrictions to be removed
- Existing pedestrian crossing controlled zone (white zig-zags)

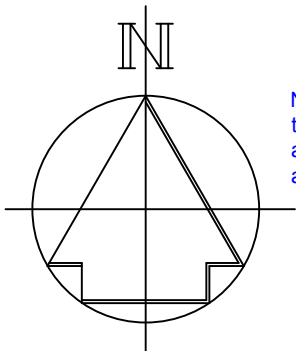

New double yellow lines to prevent parking around the junctions and on the spur road

New double yellow lines to prevent parking around the junction and in the cul-de-sac

Old double yellow lines to be removed to allow parking at the end of the old road

New double yellow lines to prevent parking between the junction and the bus stop

Revision		Date
Drawn ACB	Checked ACB	Date 11/2016
Scale 1:500 @ A4		
Drawing No. DD/580/8		Rev -





Technical Services
 Gibson Building
 Gibson Drive
 Kings Hill
 West Malling
 Kent ME19 4LZ
 Tel: 01732 844522 Fax: 01732 876317

Project Title
Local Parking Plan - Phase 9
 Formal consultation

Drawing Title
Burham
 Court Road

Key

-  Existing "No waiting at any time" (double yellow lines)
-  Existing "No waiting at any time" (double yellow lines) to be removed

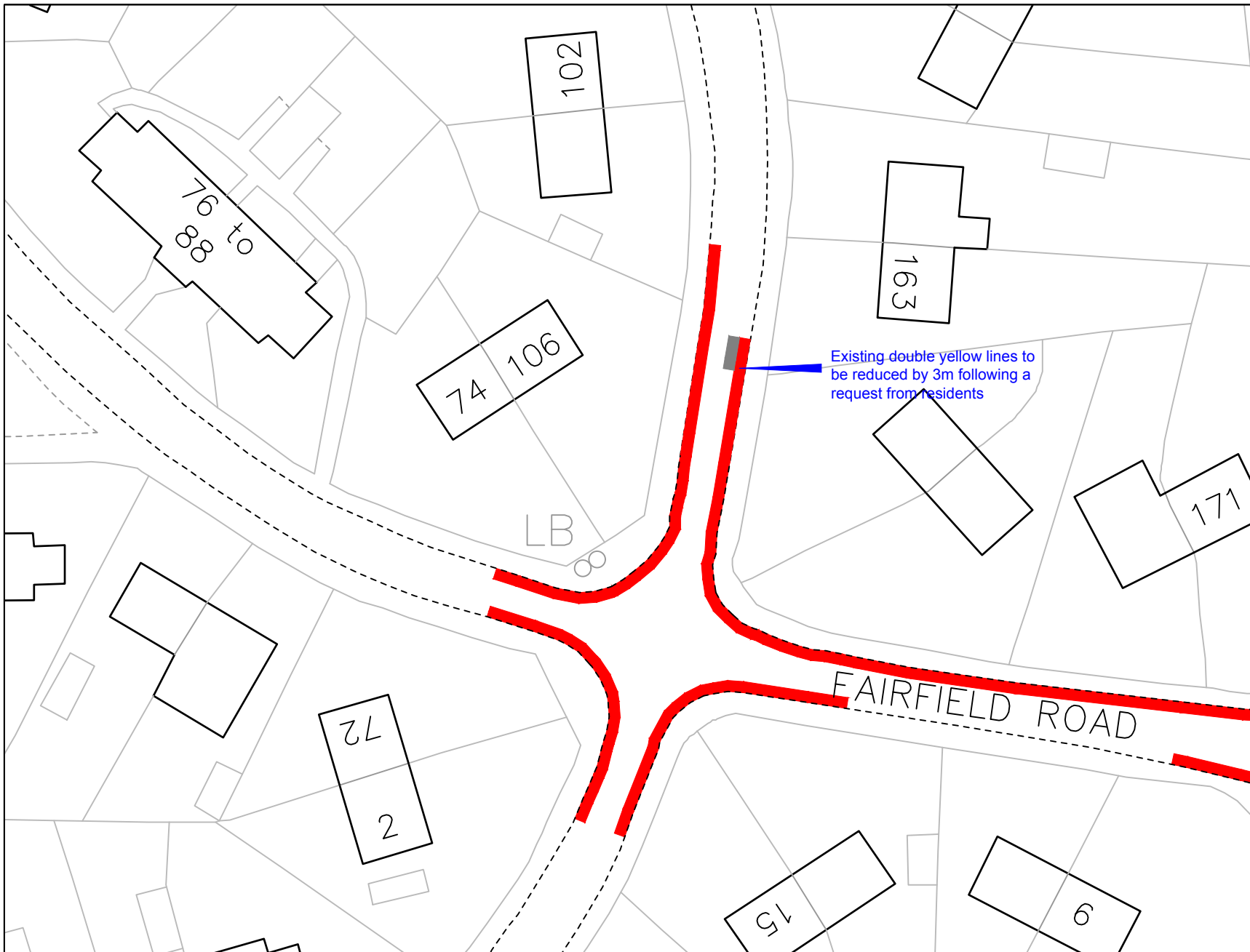

A	DYLS amended	11/17
	Revision	Date

Drawn	Checked	Date
ACB	AY	3/2017

Scale 1 :500 @ A4

Drawing No.	Rev
DD/580/09	A



STREETSCENE,
LEISURE &
TECHNICAL SERVICES

Transportation Team

Gibson Building
Gibson Drive
Kings Hill
West Malling
Kent ME19 4LZ
Tel: 01732 844522 Fax: 01732 876317

Project Title

Local Parking Plan - Phase 9
Formal consultation

Drawing Title

Borough Green
Fairfield Road

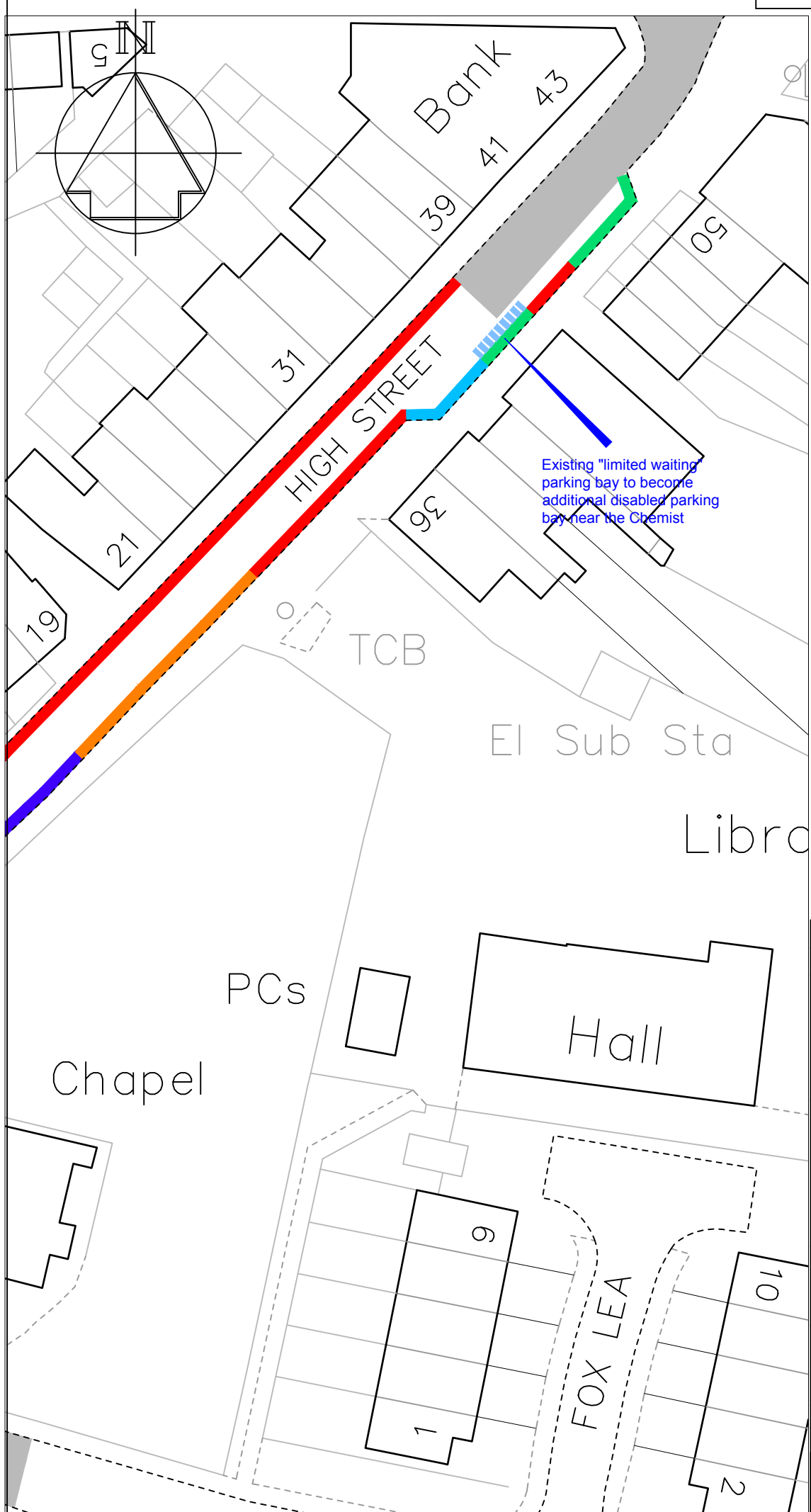

Key

- Existing "No waiting at any time" (double yellow lines)
- Existing "Limited waiting, Mon-Fri, 8am-6pm, 2hr no return 2hours and permit parking Area H" (permit parking bays)
- Existing Disabled bay
- - - Proposed Disabled bay
- Existing "Limited waiting, Mon-Sat, 8.30-6.30pm 30 minute limited waiting, no return 2 hours and permit parking" (area H) parking bays
- Existing bus stop clearway

Existing "limited waiting parking bay to become additional disabled parking bay near the Chemist

Pedestrian crossing area

Revision	Date



STREETSCENE,
LEISURE &
TECHNICAL SERVICES

Transportation Team
Gibson Building
Gibson Drive
Kings Hill
West Malling
Kent ME19 4LZ
Tel: 01732 844522 Fax: 01732 876317

Project Title
Local Parking Plan - Phase 9
Formal consultation

Drawing Title
Borough Green
High Street

Drawn ACB | Checked AY | Date 3/2017

Scale **1 : 500 @ A4**

Drawing No. DD/580/11	Rev
---------------------------------	-----

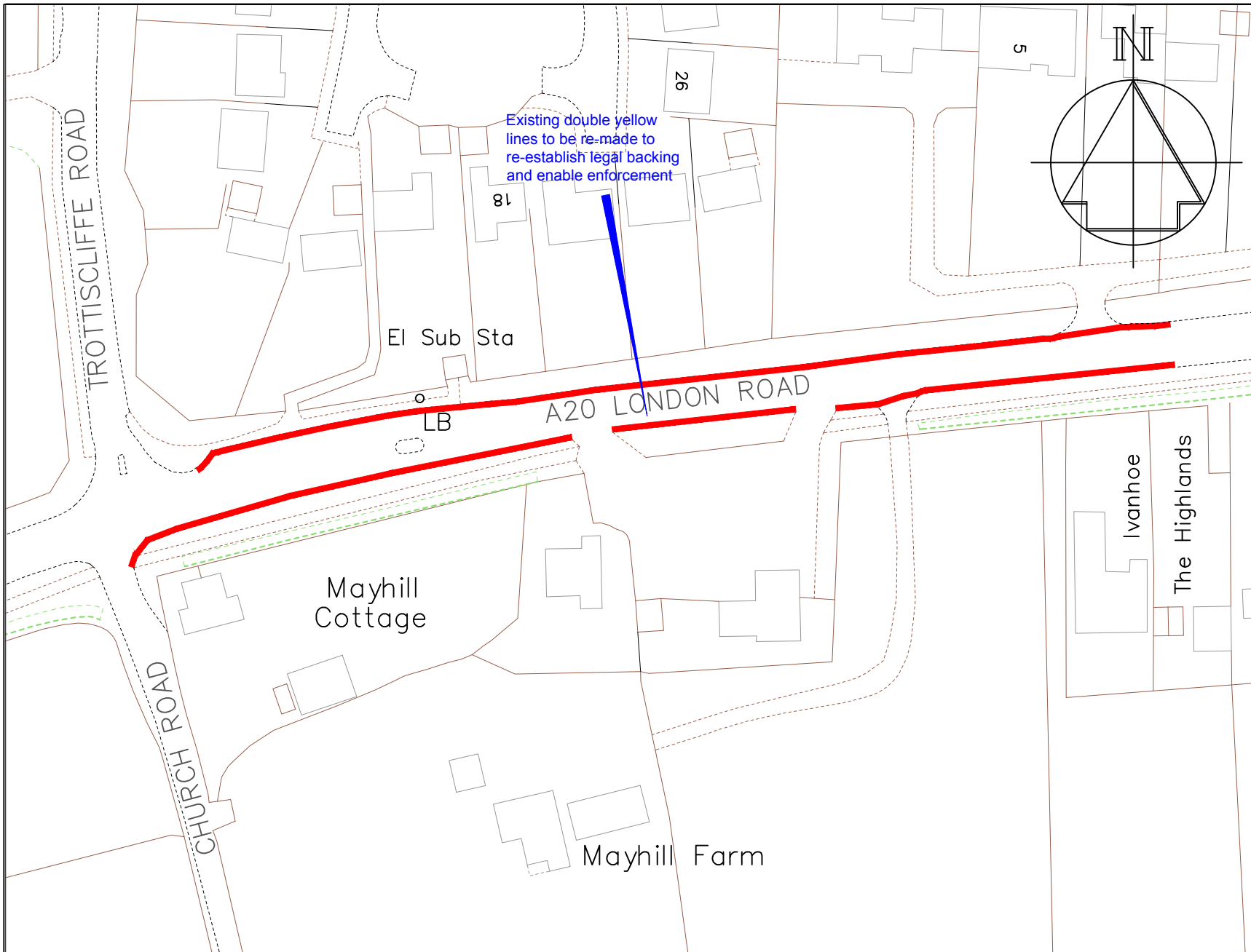

Key

 Existing 'No waiting at any time' (double yellow lines) to be re-made



Technical Services
 Gibson Building
 Gibson Drive
 Kings Hill
 West Malling
 Kent ME19 4LZ
 Tel: 01732 844522 Fax: 01732 876317

Project Title
Local Parking Plan - Phase 9
 Formal consultation

Drawing Title
Addington
 A20 London Road
 (east of Church Road)

Drawn ACB	Checked AY	Date 7/2017
Scale 1 : 1000 @ A4		
Drawing No. DD/580/13		Rev -

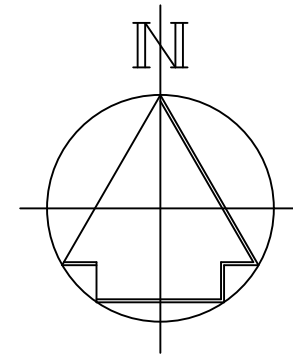

Key

 Existing 'No waiting at any time' (double yellow lines) to be re-made

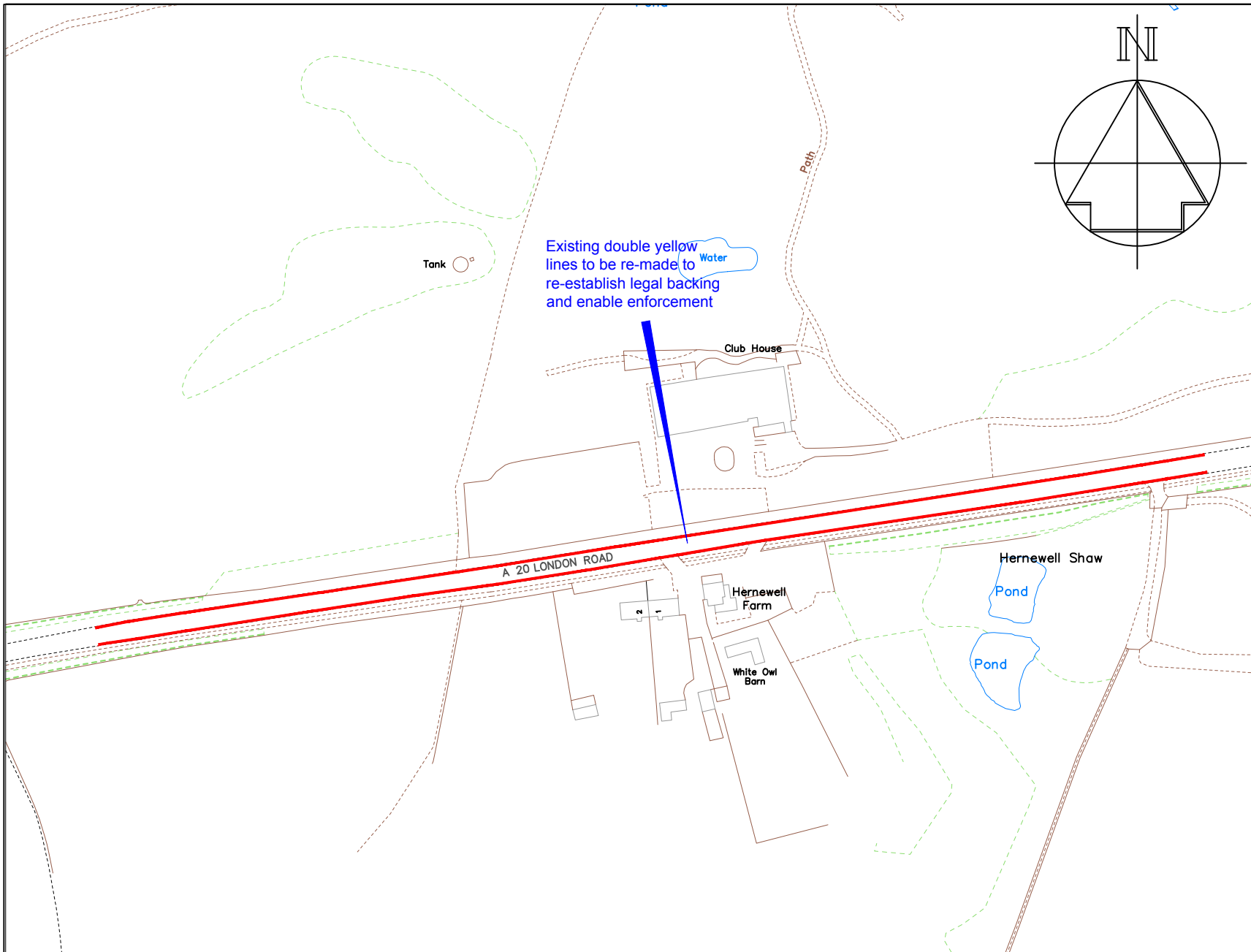

Technical Services
 Gibson Building
 Gibson Drive
 Kings Hill
 West Malling
 Kent ME19 4LZ
 Tel: 01732 844522 Fax: 01732 876317

Project Title
Local Parking Plan - Phase 9
 Formal consultation

Drawing Title
Addington
 A20 London Road
 (near Hernewell Farm)

Drawn ACB	Checked AY	Date 7/2017
Scale 1 : 2500 @ A4		
Drawing No. DD/580/14		Rev -

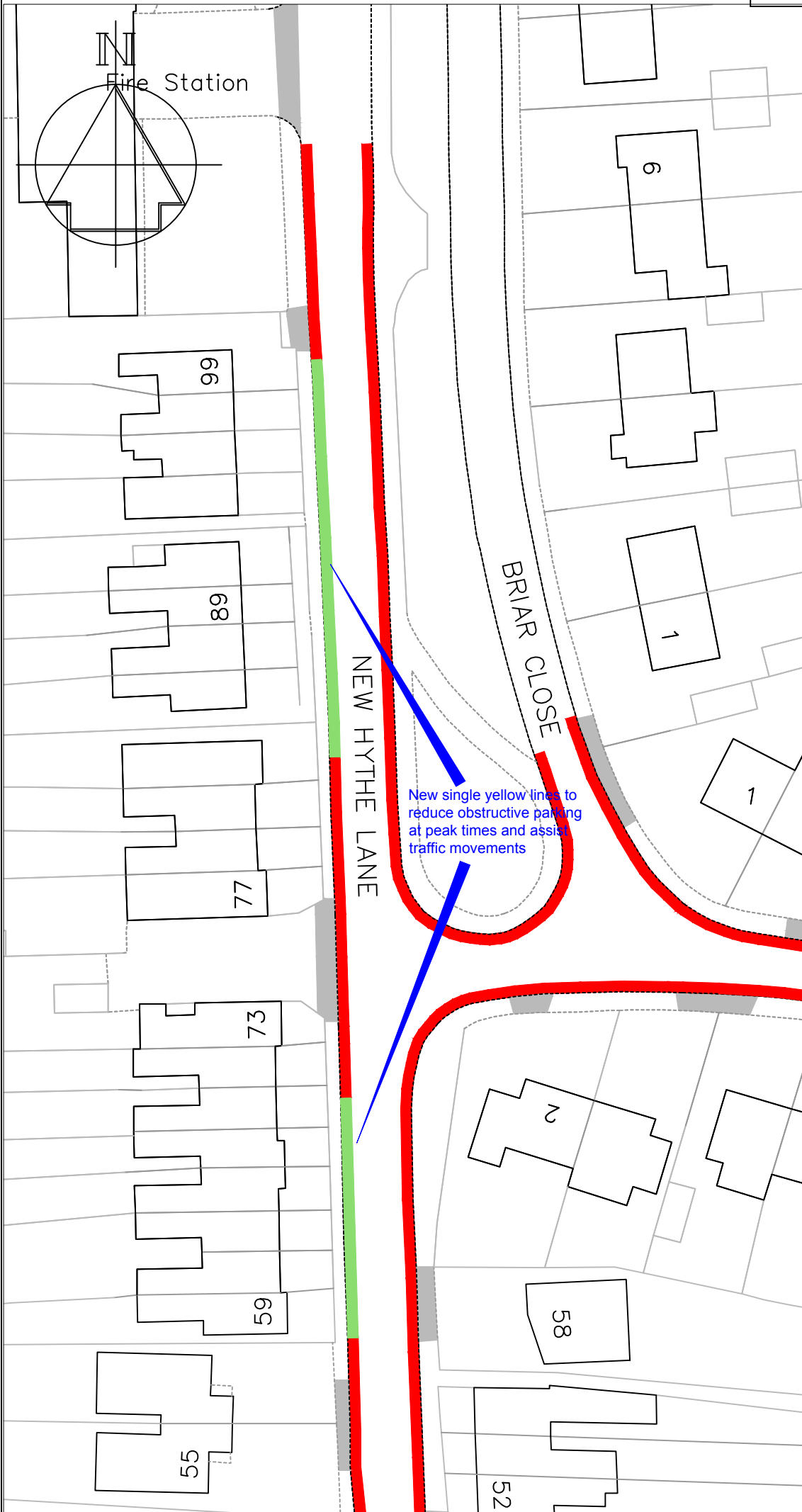

Key

- Existing "No waiting at any time" (double yellow lines)
- Existing vehicle accesses
- Proposed "No Waiting, Mon-Fri, 7:30-9am & 3-6pm" (single yellow line)

B	SYL times changed	1/18
	Revision	Date



Technical Services
 Gibson Building
 Gibson Drive
 Kings Hill
 West Malling
 Kent ME19 4LZ
 Tel: 01732 844522 Fax: 01732 876317

Project Title
Local Parking Plan - Phase 9
 Formal consultation

Drawing Title
Larkfield
 New Hythe Lane

Drawn ACB Checked AY Date 8/2015

Scale **1 : 500 @ A4**

Drawing No. DD/580/15	Rev B
--------------------------	----------

Key

- Existing 'No waiting at any time' (double yellow lines)
- Existing disabled parking bay
- Existing School Keep Clear Mon-Fri, 8am-6pm (yellow zig-zags)
- Proposed 'No waiting at any time' (double yellow lines)
- Existing limited waiting Mon-Fri 15 minutes drop-off bay
- Existing limited waiting Mon-Fri 8am-6pm, 4hours, no return 4 hours and Area K permits

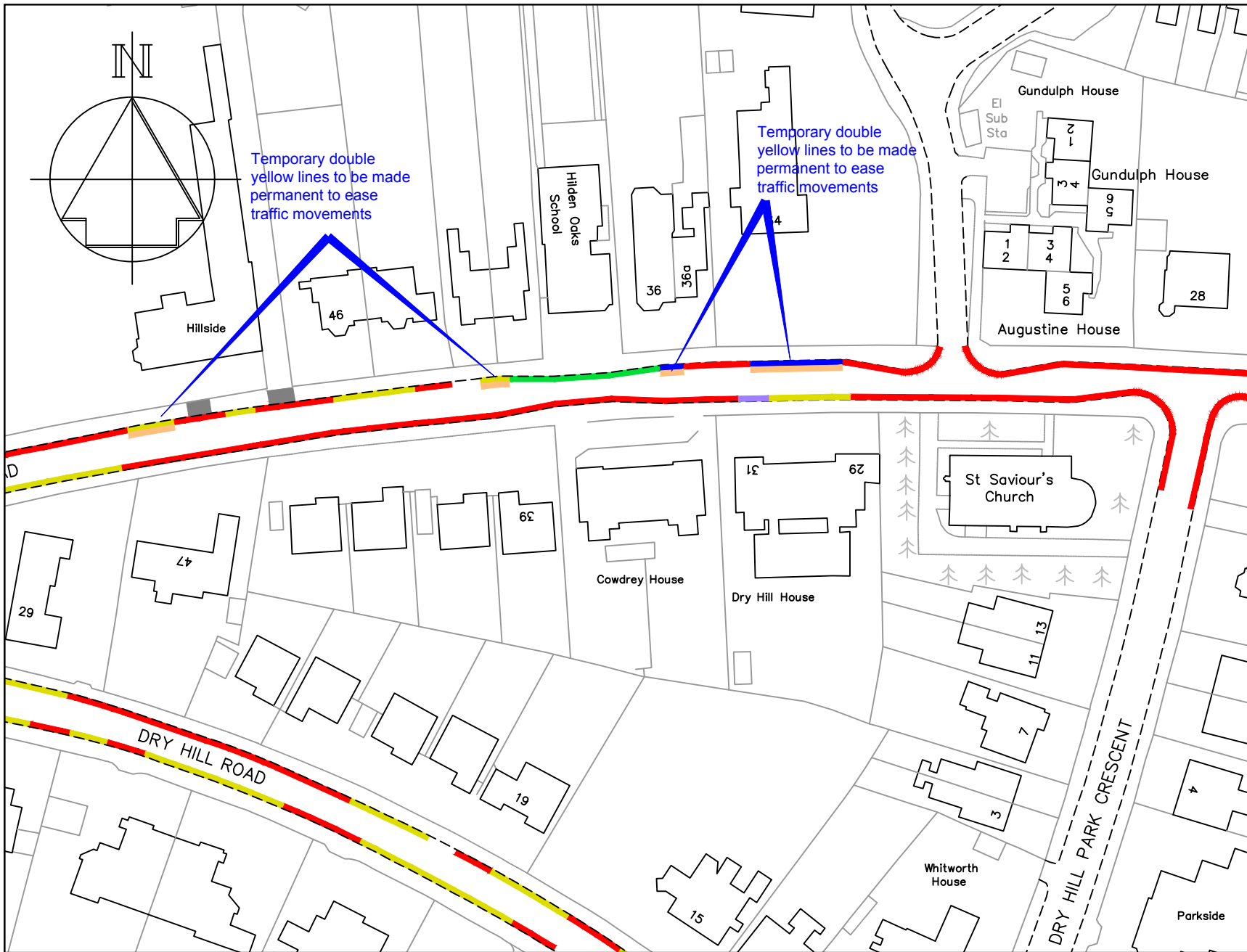

STREETSCENE,
LEISURE &
TECHNICAL SERVICES

Transportation Team

Gibson Building
Gibson Drive
Kings Hill
West Malling
Kent ME19 4LZ
Tel: 01732 844522 Fax: 01732 876317

Project Title

Local Parking Plan - Phase 9
Formal consultation

Drawing Title

Tonbridge
Dry Hill Park Road

Drawn ACB	Checked AY	Date 7/2017
---------------------	----------------------	-----------------------

Scale 1 : 1000 @ A4

Drawing No. DD/580/17	Rev
---------------------------------	-----

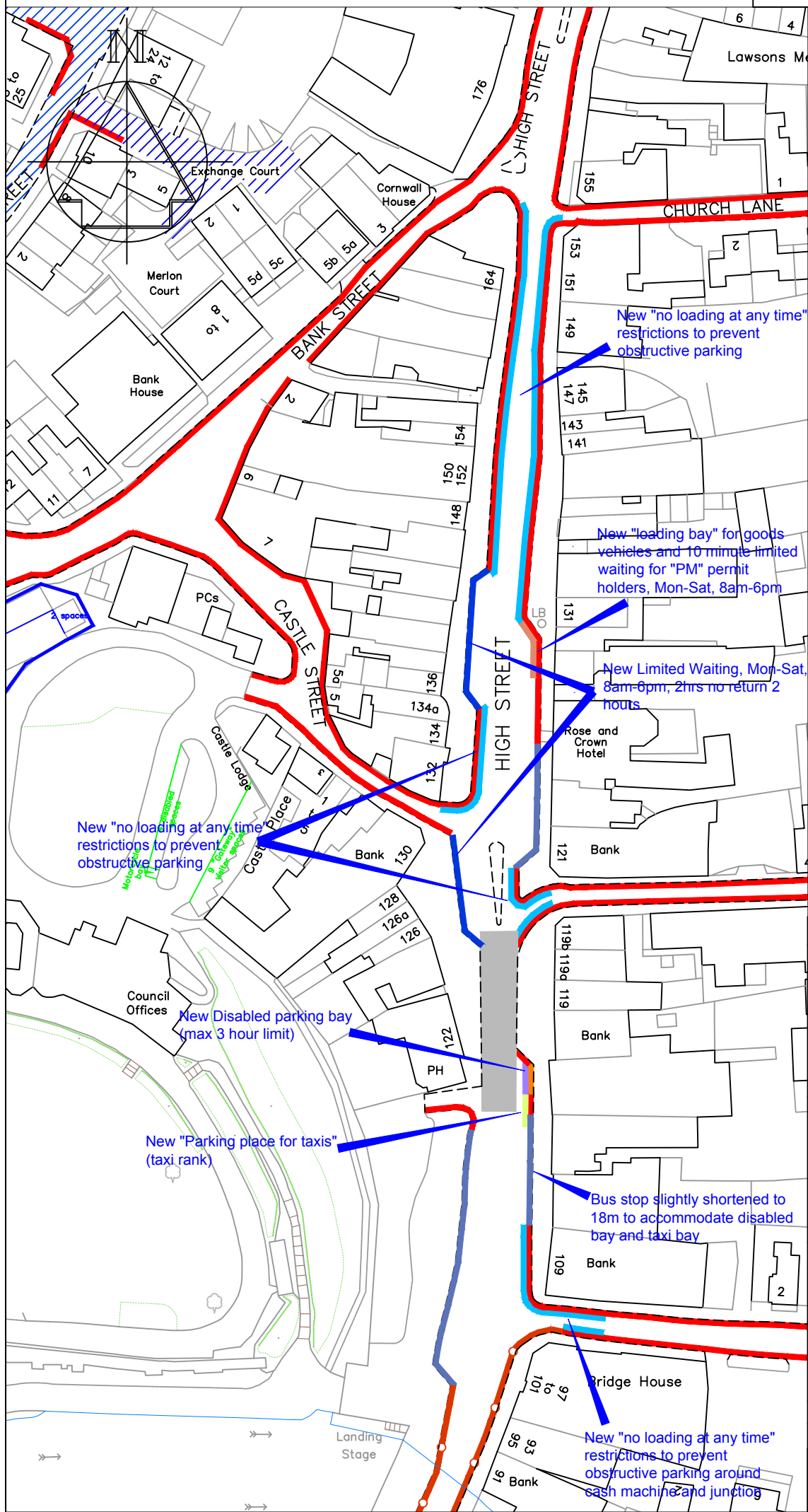

- ### Key
- Existing 'No waiting at any time' (double yellow lines)
 - Existing daytime bus stop clearway and overnight taxi rank
 - Existing taxi rank
 - New disabled parking bay
 - New Limited Waiting, Mon-Sat, 8am-6pm, 2hours, no return within 2 hours (parking bays)
 - New Loading Bay and 10 minute limited waiting for "PM" permit holders, Mon-Sat, 8am-6pm
 - New No Loading At Any Time restriction (kerb marks) to be added to existing No Waiting At Any Time (double yellow lines)
 - Existing No Loading At Any Time restriction (kerb marks) to be added to existing No Waiting At Any Time (double yellow lines)

New "no loading at any time" restrictions to prevent obstructive parking

New "loading bay" for goods vehicles and 10 minute limited waiting for "PM" permit holders, Mon-Sat, 8am-6pm

New Limited Waiting, Mon-Sat, 8am-6pm, 2hrs no return 2 hours

New "no loading at any time" restrictions to prevent obstructive parking

New Disabled parking bay (max 3 hour limit)



New "Parking place for taxis" (taxi rank)

Bus stop slightly shortened to 18m to accommodate disabled bay and taxi bay

New "no loading at any time" restrictions to prevent obstructive parking around cash machine and junction

Revision	Date
 STREETSCENE, LEISURE & TECHNICAL SERVICES	
Transportation Team Gibson Building Gibson Drive Kings Hill West Malling Kent ME19 4LZ Tel: 01732 844522 Fax: 01732 876317	
Project Title Local Parking Plan - Phase 9 Formal consultation	
Drawing Title Tonbridge High Street	
Drawn ACB	Checked AY
Date 8/2015	
Scale 1 : 1000 @ A4	
Drawing No. DD/580/18	Rev

Key

-  Housing Association parking bay
-  Proposed "No waiting at any time" (double yellow lines)

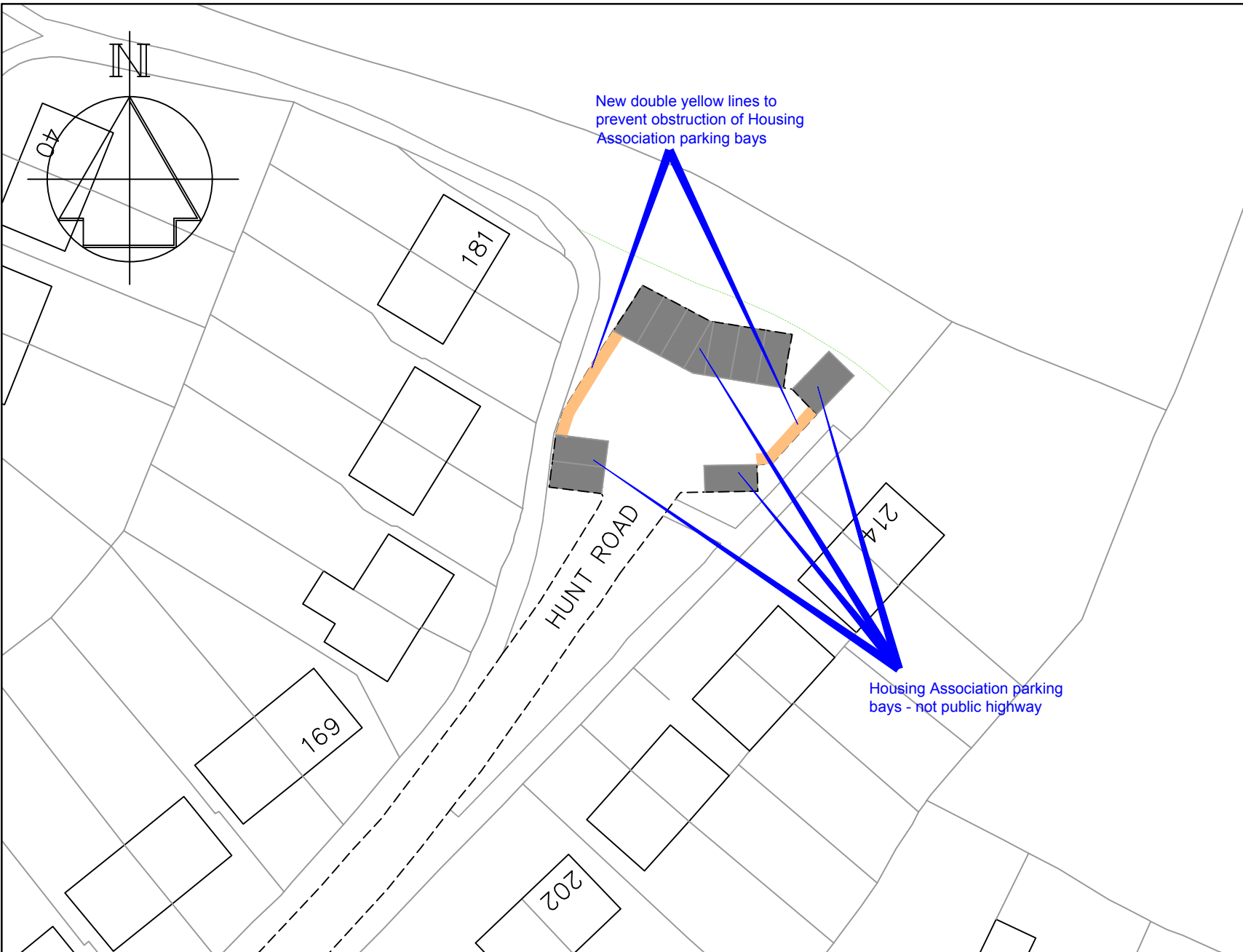

STREETSCENE,
LEISURE &
TECHNICAL SERVICES

Transportation Team

Gibson Building
Gibson Drive
Kings Hill
West Malling
Kent ME19 4LZ
Tel: 01732 844522 Fax: 01732 876317

Project Title

Local Parking Plan - Phase 9
Formal consultation

Drawing Title

Tonbridge
Hunt Road

Drawn ACB	Checked AY	Date 7/2017
Scale 1 : 500 @ A4		
Drawing No. DD/580/19		Rev

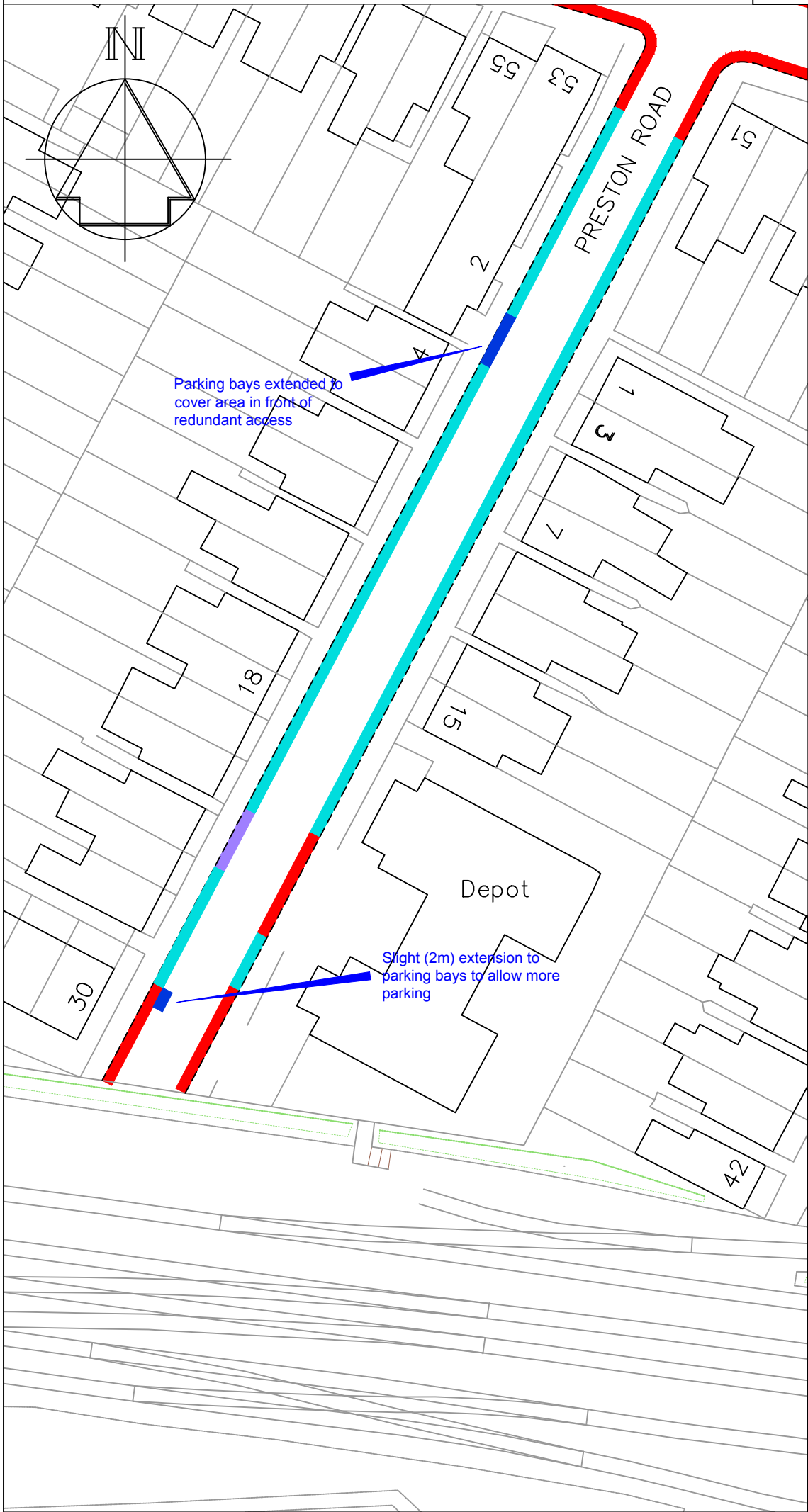

Key

- Existing "No waiting at any time" (double yellow lines)
- Existing "D1" permit parking bay
- Existing Disabled bay
- Proposed "D1" permit parking bay

Parking bays extended to cover area in front of redundant access

Slight (2m) extension to parking bays to allow more parking

Revision	Date



STREETSCENE,
LEISURE & TECHNICAL
SERVICES

Transportation Team
Gibson Building
Gibson Drive
Kings Hill
West Malling
Kent ME19 4LZ
Tel: 01732 844522 Fax: 01732 876317

Project Title
Local Parking Plan - Phase 9
Formal consultation

Drawing Title
Tonbridge
Preston Road



Drawn ACB | Checked AY | Date 8/2015

Scale **1 : 500 @ A4**

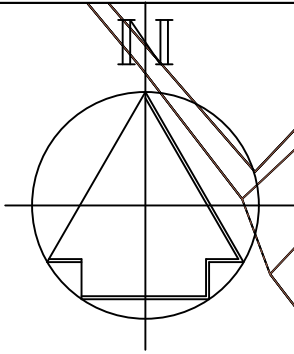
Drawing No. DD/580/20	Rev
---------------------------------	-----



Key

-  Existing 'No waiting at any time' (double yellow lines)
-  Existing disabled persons parking bay, adjusted to new standard 6.6m length

Existing disabled parking bay - to be re-defined on Order to new standard 6.6m length

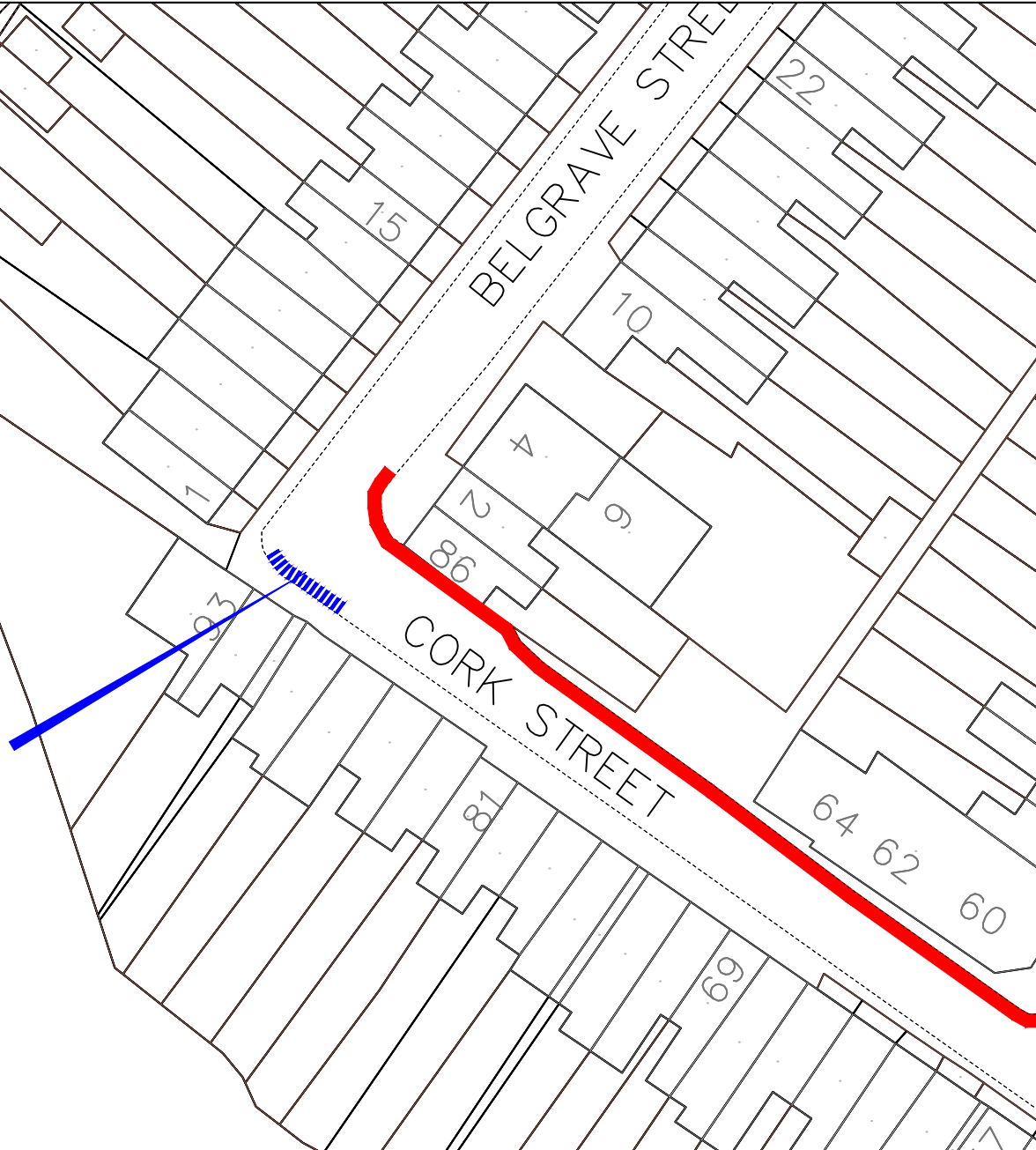

Technical Services
 Gibson Building
 Gibson Drive
 Kings Hill
 West Malling
 Kent ME19 4LZ
 Tel: 01732 844522 Fax: 01732 876317

Project Title
 Local Parking Plan - Phase 8
 Formal consultation

Drawing Title
 Eccles
 Cork Street / Belgrave Street

Drawn ACB	Checked AY	Date 7/2017
--------------	---------------	----------------

Scale 1 : 500 @ A4

Drawing No. DD/580/21	Rev -
--------------------------	----------

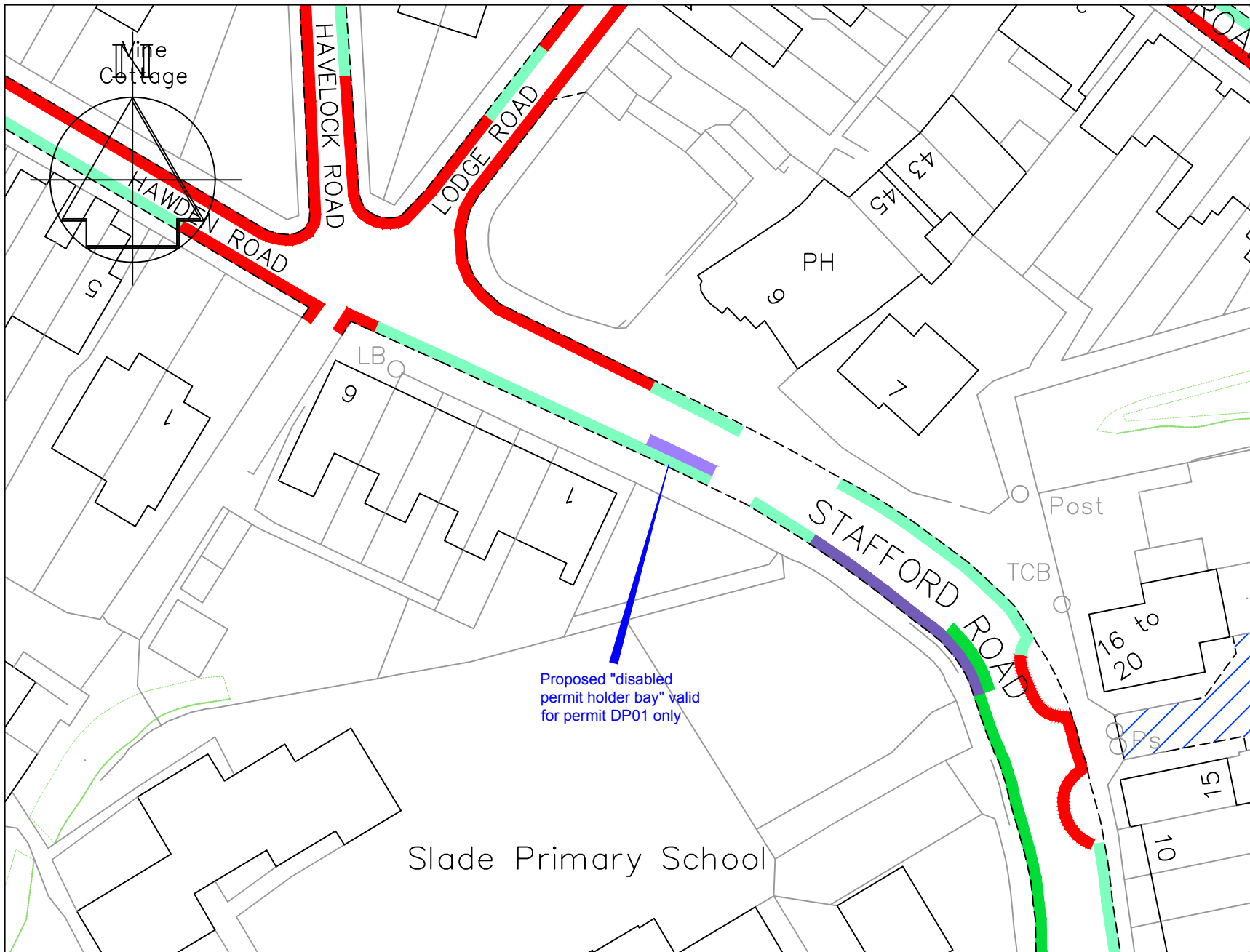

Key

- Existing 'No waiting at any time' (double yellow lines)
- Existing Area J permit parking bay
- Existing School Keep Clear
- Existing No Waiting 7am-7pm
- ▭ Proposed "disabled permit holder" bay for permit DP01, issued to a local resident who meets the County Council's disability criteria



STREETSCENE,
LEISURE &
TECHNICAL SERVICES

Transportation Team

Gibson Building
Gibson Drive
Kings Hill
West Malling
Kent ME19 4LZ
Tel: 01732 844522 Fax: 01732 876317

Project Title

Local Parking Plan - Phase 9
Formal consultation

Drawing Title

Tonbridge
Stafford Road

Drawn ACB	Checked AY	Date 8/2015
---------------------	----------------------	-----------------------

Scale 1 : 500 @ A4

Drawing No. DD/580/22	Rev
---------------------------------	-----

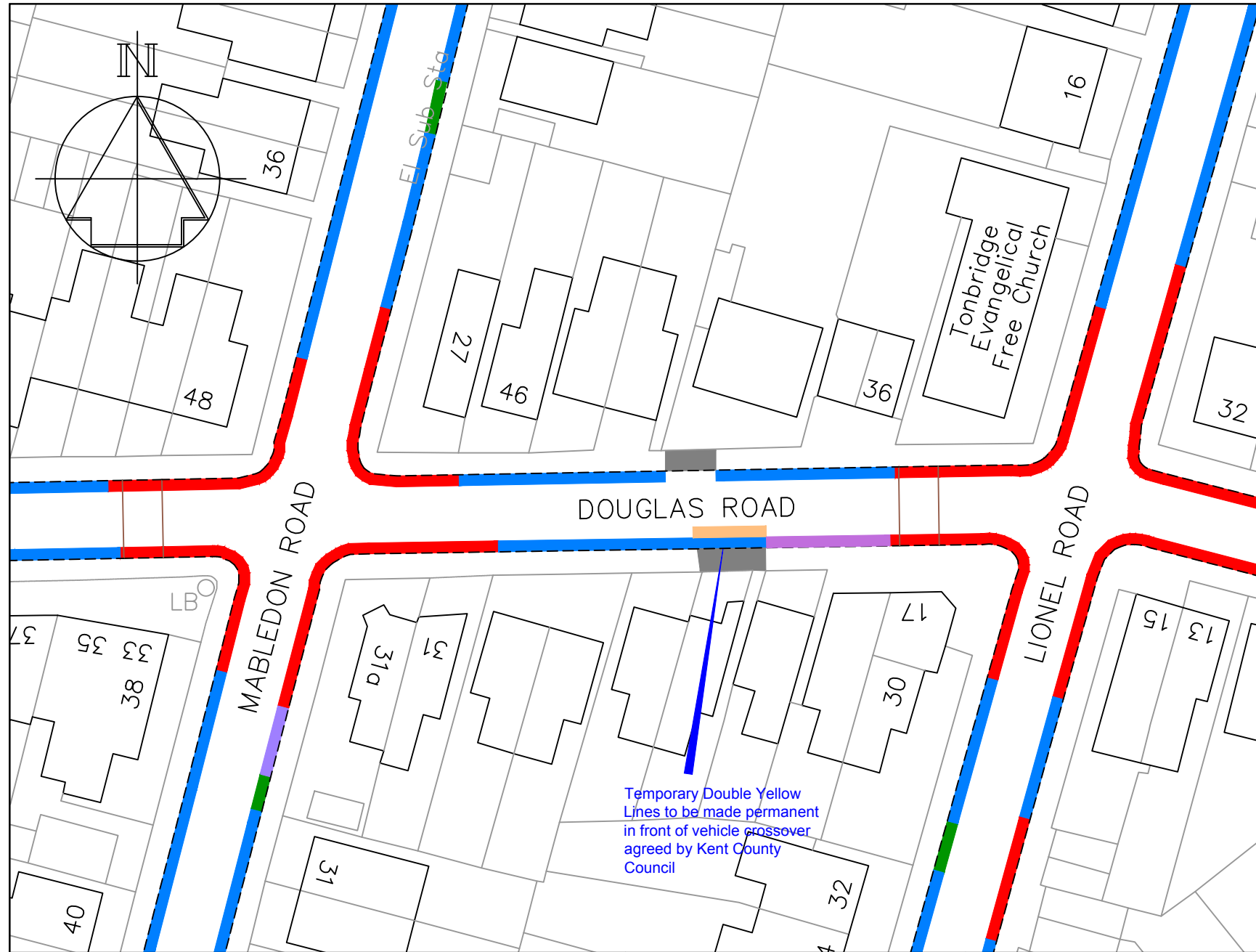

- ### Key
- Existing 'No waiting at any time' (double yellow lines)
 - Existing Area G permit parking bay
 - Existing Area G permit parking and limited waiting, Mon-Sat, 8am-6pm, 2 hour, no return 2 hours parking bay
 - Existing temporary 'No waiting at any time' (double yellow lines) to become permanent
 - Existing white access marking
 - Existing disabled parking bay



STREETSCENE,
LEISURE &
TECHNICAL SERVICES

Transportation Team
Gibson Building
Gibson Drive
Kings Hill
West Malling
Kent ME19 4LZ
Tel: 01732 844522 Fax: 01732 876317

Project Title
Local Parking Plan - Phase 9
Formal consultation

Drawing Title
Tonbridge
Douglas Road (near No.23)

Drawn ACB	Checked AY	Date 8/2015
Scale 1 : 500 @ A4		
Drawing No. DD/580/23		Rev

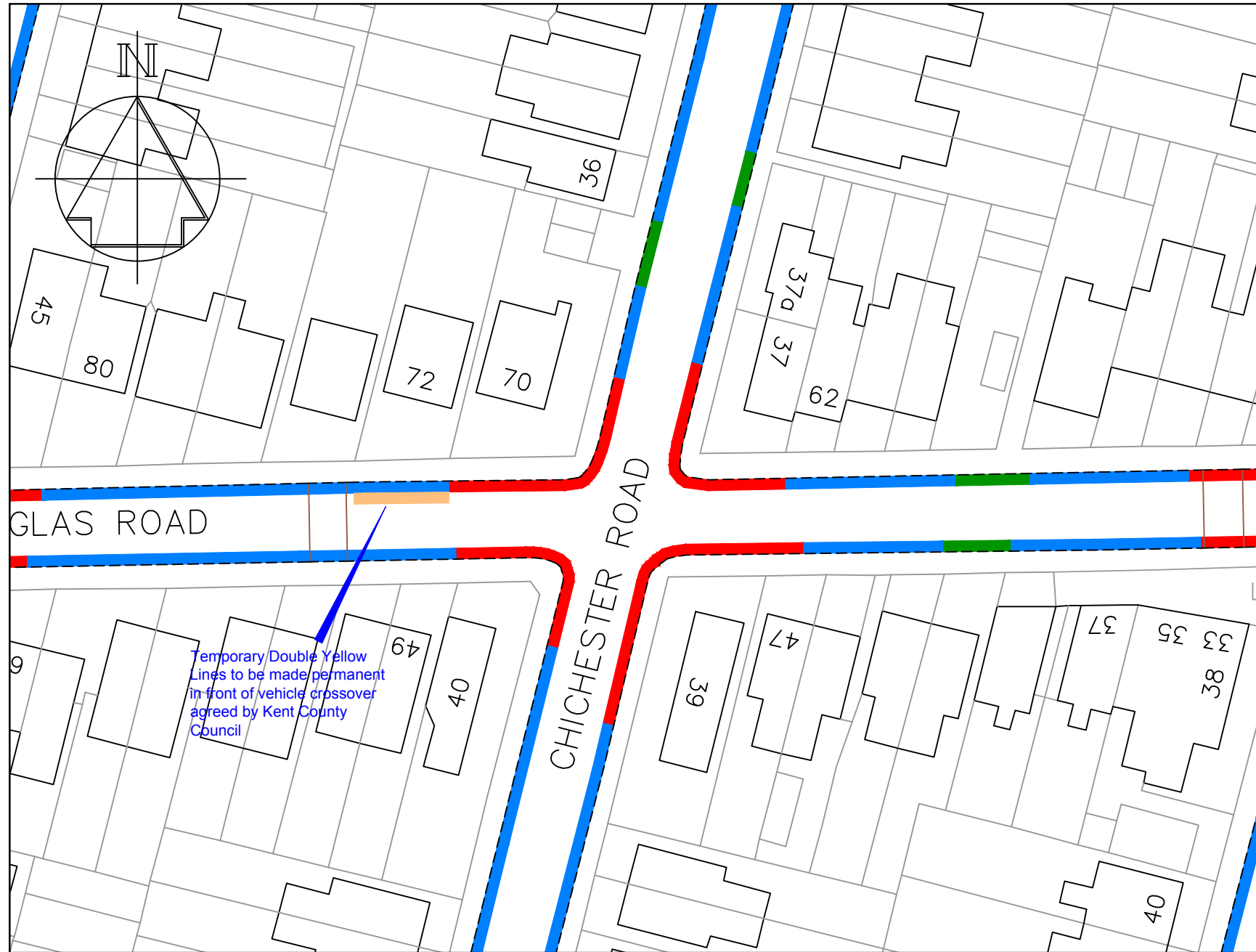

Key

- Existing 'No waiting at any time' (double yellow lines)
- Existing Area G permit parking bay
- Existing temporary 'No waiting at any time' (double yellow lines) to become permanent
- Existing white access marking

Temporary Double Yellow Lines to be made permanent in front of vehicle crossover agreed by Kent County Council



STREETSCENE,
LEISURE &
TECHNICAL SERVICES

Transportation Team
Gibson Building
Gibson Drive
Kings Hill
West Malling
Kent ME19 4LZ
Tel: 01732 844522 Fax: 01732 876317

Project Title
Local Parking Plan - Phase 9
Formal consultation

Drawing Title
Tonbridge
Douglas Road (near No.72)

Drawn ACB	Checked AY	Date 8/2015
---------------------	----------------------	-----------------------

Scale **1 : 500 @ A4**

Drawing No. DD5/580/24	Rev
----------------------------------	-----

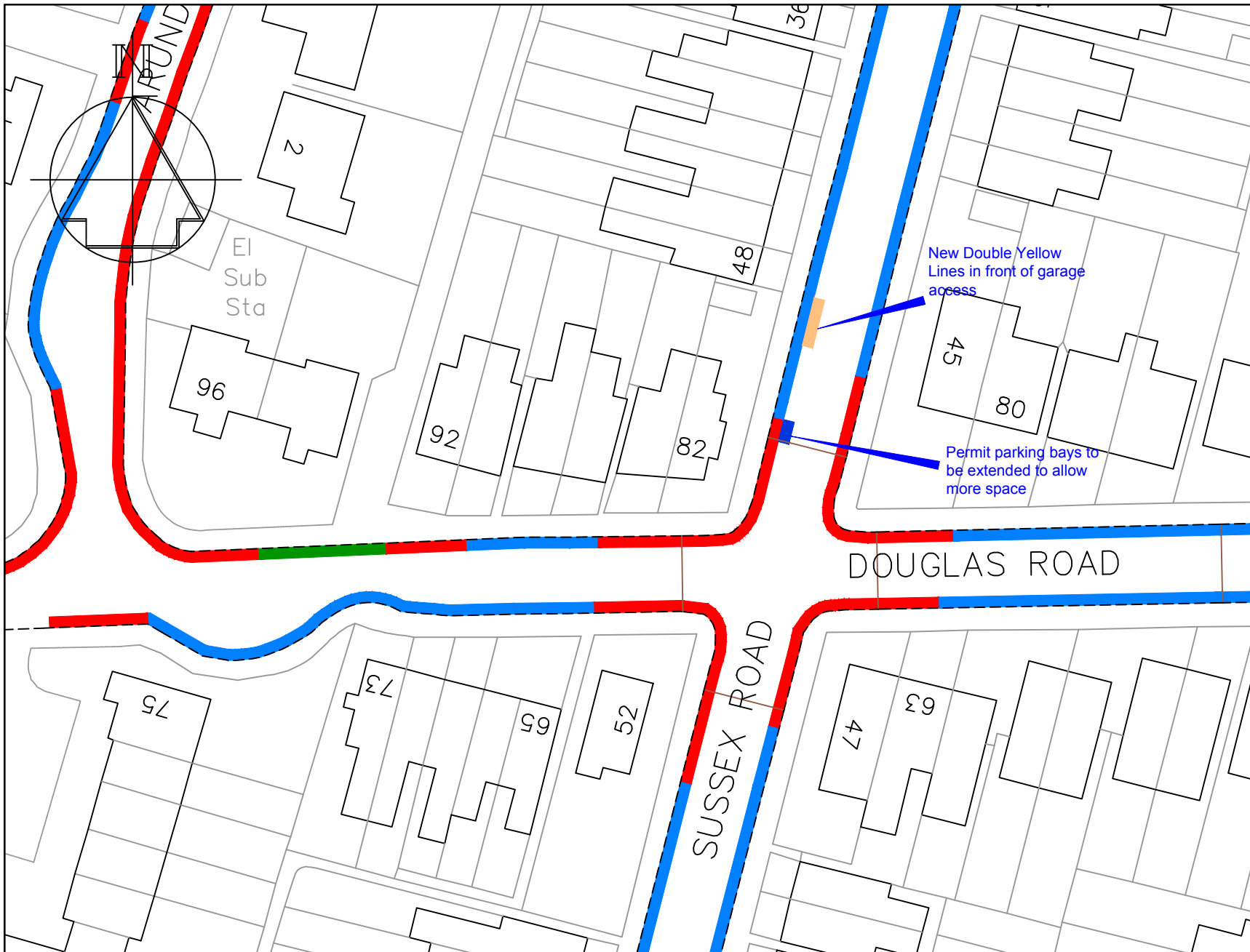

Key

- Existing 'No waiting at any time' (double yellow lines)
- Existing Area G permit parking bay
- Proposed Area G permit parking bay
- Existing temporary 'No waiting at any time' (double yellow lines) to become permanent
- Existing white access marking



STREETSCENE,
LEISURE &
TECHNICAL SERVICES

Transportation Team

Gibson Building
Gibson Drive
Kings Hill
West Malling
Kent ME19 4LZ
Tel: 01732 844522 Fax: 01732 876317

Project Title

Local Parking Plan - Phase 9
Formal consultation

Drawing Title





Tonbridge
Sussex Road (side of 82 Douglas Road)

Drawn ACB	Checked AY	Date 8/2015
---------------------	----------------------	-----------------------

Scale 1 : 500 @ A4

Drawing No. DD/580/25	Rev
---------------------------------	-----

Key

-  Existing "No waiting at any time" (double yellow lines)
-  Existing permit parking bays
-  Vehicle crossover
-  Proposed "No waiting at any time" (double yellow lines)

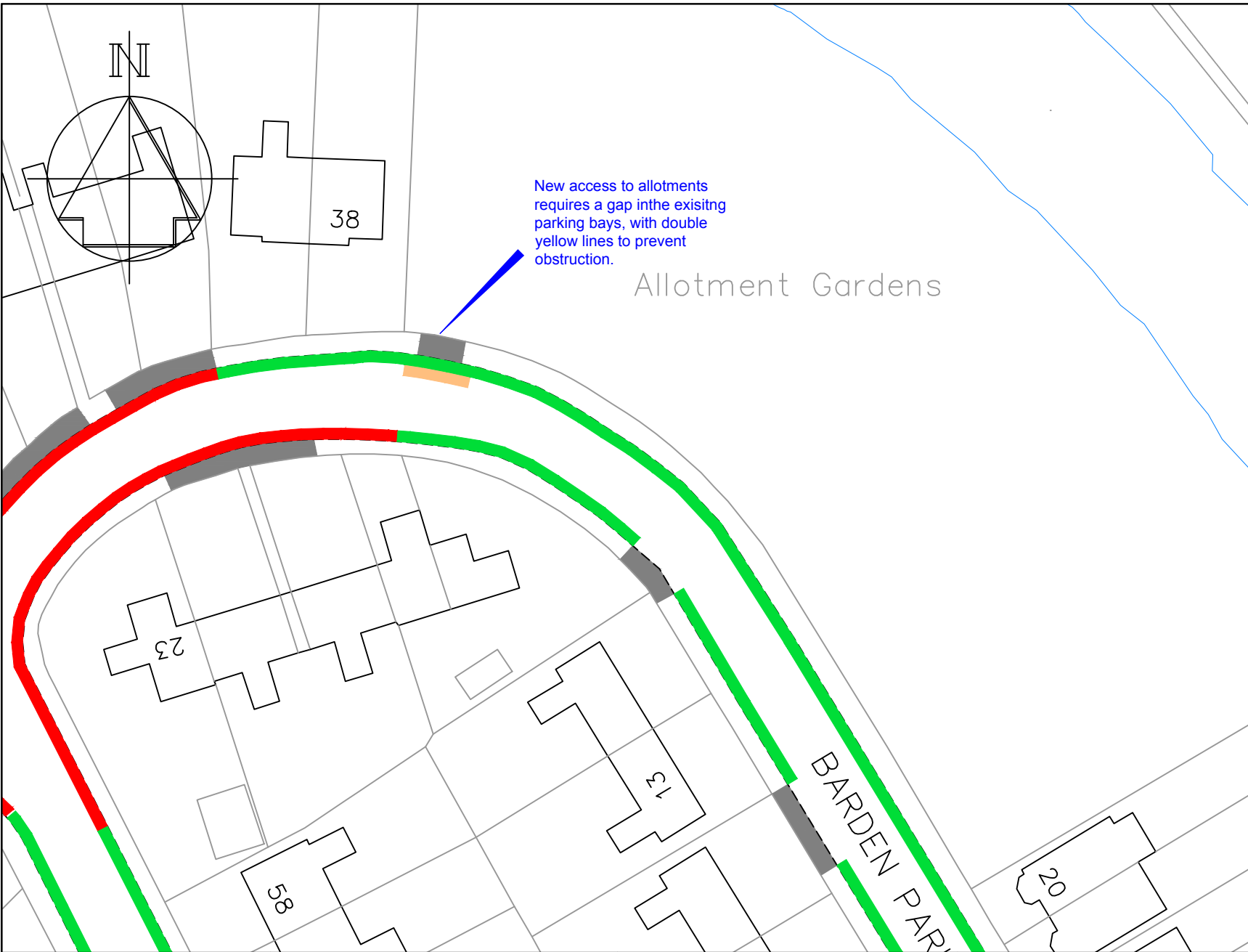

STREETSCENE,
LEISURE &
TECHNICAL SERVICES



Transportation Team
Gibson Building
Gibson Drive
Kings Hill
West Malling
Kent ME19 4LZ
Tel: 01732 844522 Fax: 01732 876317

Project Title
Local Parking Plan - Phase 9
Formal consultation

Drawing Title
Tonbridge
Barden Park Road

Drawn ACB	Checked AY	Date 8/2015
Scale 1 : 500 @ A4		
Drawing No. DD/580/26		Rev

Key

-  Proposed 'No waiting at any time' (double yellow lines) in front of new access approved by Kent County Council
-  Existing Mon-Fri 10am-11am Area P permit parking bay

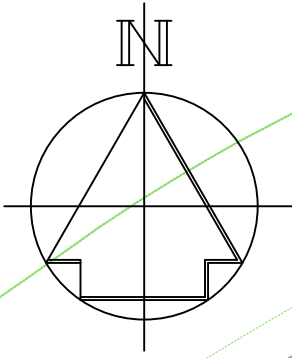

Permit parking bay to be removed due to new vehicle access. New Double yellow lines to prevent obstruction

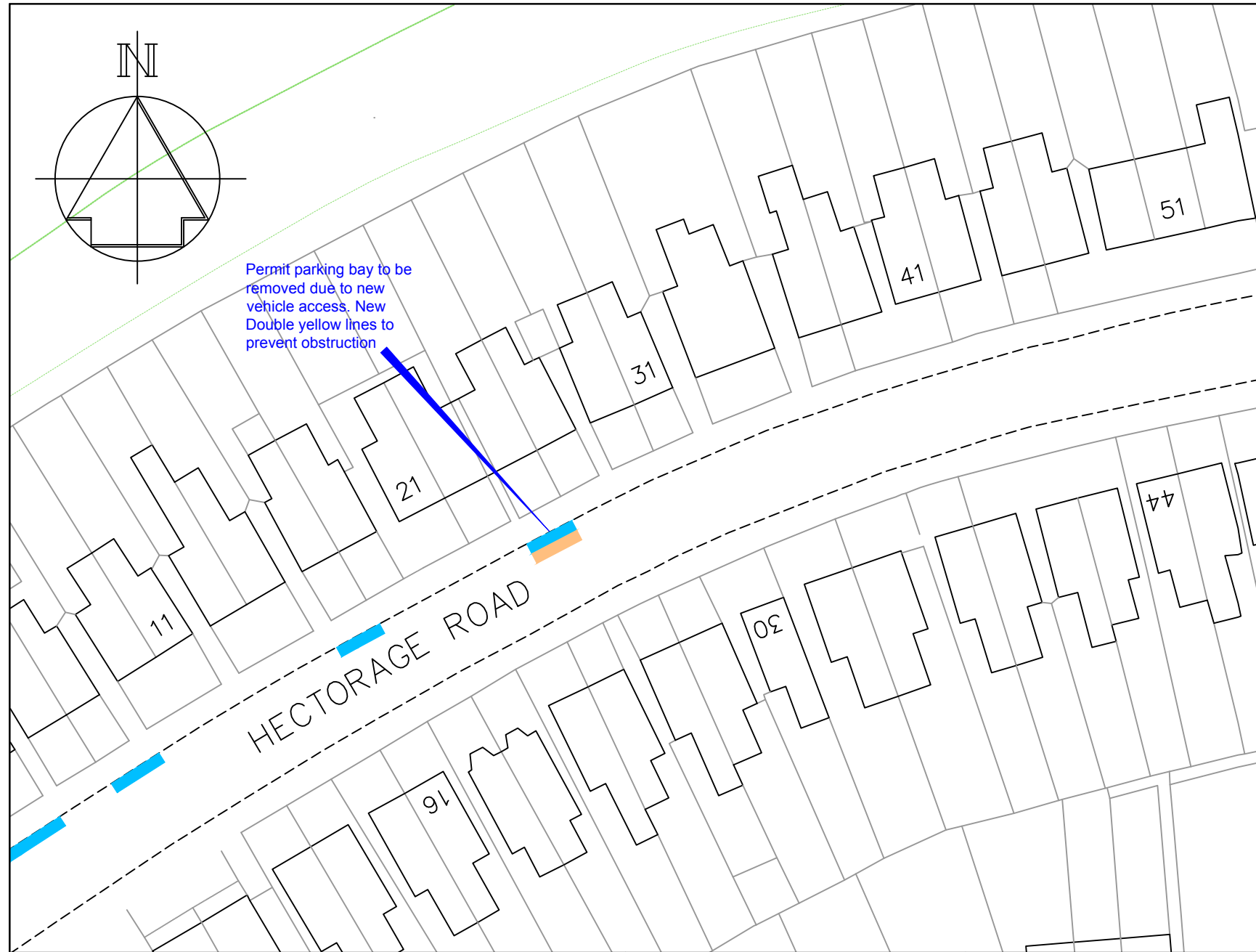

STREETSCENE,
LEISURE &
TECHNICAL SERVICES

Transportation Team
Gibson Building
Gibson Drive
Kings Hill
West Malling
Kent ME19 4LZ
Tel: 01732 844522 Fax: 01732 876317

Project Title
Local Parking Plan - Phase 9
Formal consultation

Drawing Title
Tonbridge
Hectorage Road

Drawn ACB	Checked AY	Date 8/2015
Scale 1 : 500 @ A4		
Drawing No. DD/580/27		Rev